

product technical sheet

collection	PROP
code	EVBAPK1B - EVBAPK1N
description	Vertical bar (H 1140 mm) complete with mirror, hook, shelf and shelf with tumblers
certifications	TUV system certification UNI EN ISO 9001.
performances	Load capacity 120 Kg.
features	Configuration Prop with support bar made of extruded aluminium , wall mounted, (H 1140 mm) complete with hook, shelf, shelf with tumblers and rounded mirror mounted on adjustable bracket, to allow the regulation of the position of the mirror. Painted mat white or mat black.
size	1140 x 762.5 x 178 mm
installation	Wall fixation of the brackets with 4 screws and fasteners, included in the package. Fasteners type UX 6X35. Verify that the type of fasteners provided are suitable for the type wall on which you are going to install the product, if not, choose a different proper fastener. Verify the solidity of the installation of the bar.
finishes	EVBAPK1B: painted color mat white EVBAPK1N: painted color mat black
maintenance	Clean properly with soap and water, do not use aggressive, abrasive, corrosive, acidic, acetone, thinner etc products. Do not scratch the surface. Check periodically the correct fixation and the solidity of the installation. Do not use the product for purposes other than those intended.
materials	Extruded aluminium, glass.

ST_PRODOTTO: EVBAPK1B - EVBAPK1N - REV. 01 del 26/10/2021 - 27/01/25 - APPROVED T.D.

product technical sheet

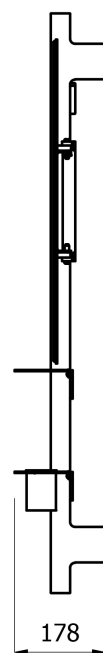
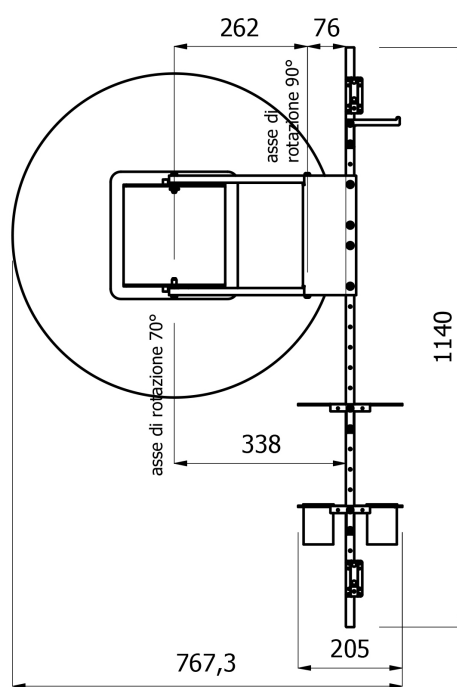
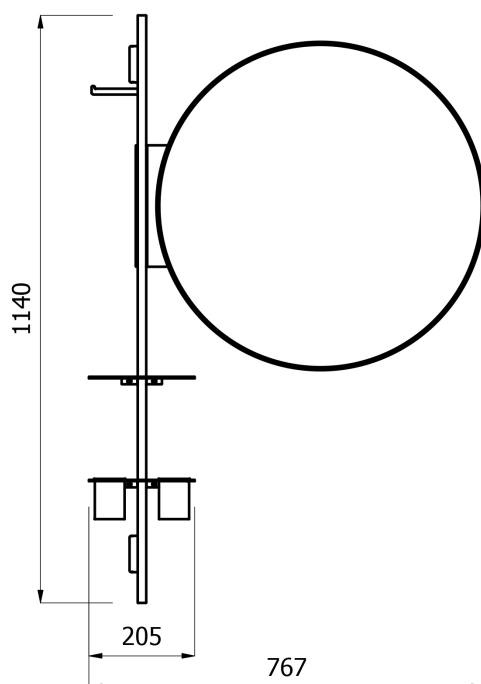
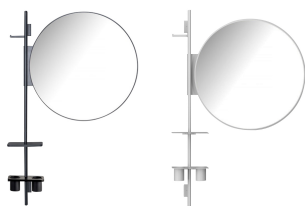

ST_PRODOTTO: EVBAPK1B - EVBAPK1N - REV. 01 del 26/10/2021 - 27/01/25 - APPROVED T.D.

product technical sheet

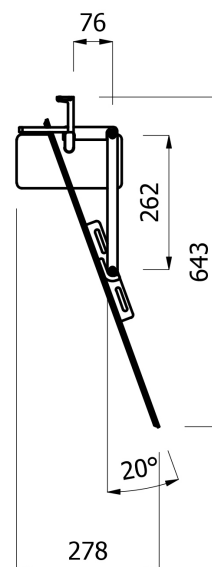
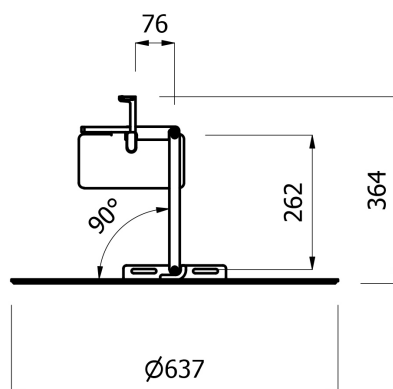

ST_PRODOTTO: EVBAPK1B - EVBAPK1N - REV. 01 del 26/10/2021 - 27/01/25 - APPROVED T.D.